



About the BLB

The BLB is an architectural overbed fixture designed for use in hospitals and long-term care facilities.

Specifications

Supported Voltage	120-277V, 347V, 120-347V
Available Sizes	2', 3', 4'
Lifetime	L70 of 100,000+ hours
Lumens	Down 1L-4L, Up 1L-4L
CCT	2700K, 3000K, 3500K, 4000K, 5000K, 6500K
CRI	80+ standard, 90+ and 95+ available
Dimming	0-10V
Mounting	Surface-mount

Approvals

- Made with UL Listed components

Ordering Information

BLB	3'	2L	2L	835	UN3	L	S2	W39	S1	B11	L76
Fixture Series	Size	Up Output		Voltage		Main Switch	NightLight		NightLight Switch	Dimming	
1	2	3		4		5		6			

1	2	3	4	5	6
BLB					

Series	Size	Down Lm	Up Lm	CRI	CCT	
BLB	2'	2'-1L 1000lm	2'-1L 1000lm	8 80	27 2700K	
		2'-1.25 1250lm	2'-1.25 1250lm	9 90+	30 3000K	
	3'	2'-1.5L 1500lm	2'-1.5L 1500lm	1 95+	35 3500K	
		3'-1.5L 1500lm	3'-1.5L 1500lm		40 4000K	
	4'	3'-2.25L 2250lm	3'-2.25L 2250lm		50 5000K	
		3'-3L 3000lm	3'-3L 3000lm		65 6500K	
		4'-2L 2000lm	4'-2L 2000lm			
		4'-3L 3000lm	4'-3L 3000lm			
			4'-4L 4000lm	4'-4L 4000lm		

7	8	9	10	11	12	13

Voltage	Switch Location	Main Switch	NightLight	NightLight Switch	Dimming	Lens
UNV 120-277V	L Left	BLANK None	BLANK None	S1 Pull Chain	BLANK 0-10V	L0 No Lens
347 347V	R Right	S1 Pull Chain	W39 Candelabra	On/Off	B10 DALI	L76 Frosted
UN3 120-347V		On/Off	Bulb	S5 Toggle	B11 0-10V	Acrylic
					Dimming Leads	L99 Custom Lens



14

Options

<p>Lenses</p> <ul style="list-style-type: none"> L0 No Lens L76 Frosted Lens L99 Custom Lens <p>Switch Location</p> <ul style="list-style-type: none"> BLANK None S1 Pull Chain On/Off S2 Pull Chain 4 Position (down, up, up&down, off) <p>NightLight</p> <ul style="list-style-type: none"> BLANK None W39 Candelabra Bulb NightLight 	<p>NightLight Switch</p> <ul style="list-style-type: none"> BLANK None S1 Pull Chain On/Off S5 Toggle <p>Dimming</p> <ul style="list-style-type: none"> B10 DALI B11 0-10V Dimming Leads B12 Line Voltage Dimming B27 Dim-to-off Driver B** Other Options Available* <p>Emergency Driver</p> <ul style="list-style-type: none"> B17 UL924 10W Battery Back-up F8 UL924 Emergency Relay 	<p>Finish</p> <ul style="list-style-type: none"> BLANK Standard Matte White with Silver Ion Technology C5 Matte Black CUSTOM* Custom Colour Choice <p>Packaging</p> <ul style="list-style-type: none"> BLANK Individually Boxed on Pallets P0 Bulk Packaging P** Other Options Available* <p>Warranty</p> <ul style="list-style-type: none"> CL7 10-Year Comprehensive Warranty Upgrade
--	---	---

Certifications and Listings

Certifications that apply to this fixture and its possible configurations are listed here. More information available upon request.

Icon	Description
	Wireless Controls Available
	90 and 95+ CRI Options Available
	120-347V(UN3) Available

Usage Applications

This fixture can be used in a variety of applications, and is ideal for the following:

Usage Application
Hospitals
Long-Term Care

Warranty Statement

BJ Take products are tested and/or inspected prior to being packaged for shipment and are guaranteed from the day the product is shipped for a period of ten-year LED chip warranty and a five-year comprehensive component warranty. This can be upgraded to a ten-year comprehensive warranty on request.

BLB 1x4 Side Dimensions

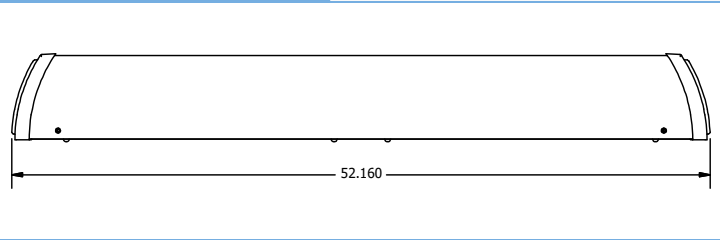

1x4 End Dimensions

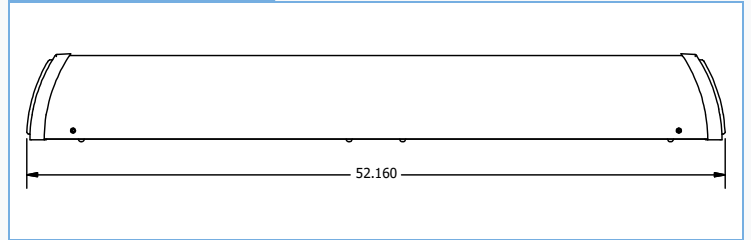

BLB 2x2 Side Dimensions

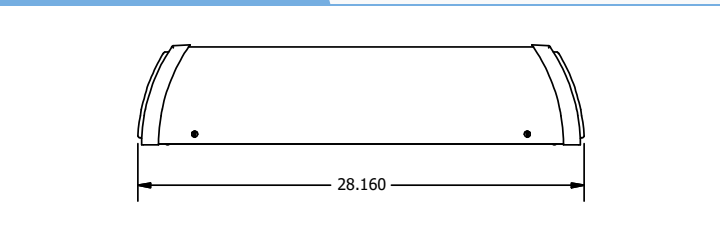

2x2 End Dimensions

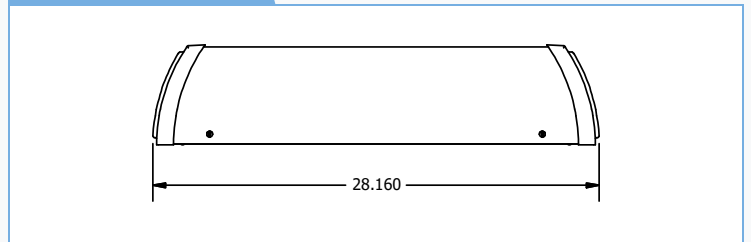

All Sizes End Dimensions

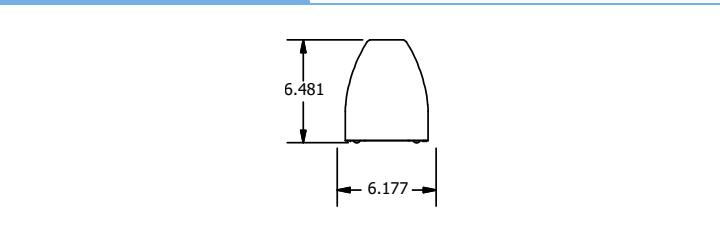

BLB Wattage

DownLight Output	DownLight Wattage	UpLight Output	UpLight Wattage
A	B	C	D
1	8.9	1	8.9
125	11.4	125	11.4
15	13.9	15	13.9
2	19	2	19
225	20.9	225	20.9
3	29	3	29
4	40.9	4	40.9

* Drawings aren't to scale

* Standard tolerances apply

* Specifications may change without notice

Gallery Information

Below you will find images of relevant products and configurations for the BLB.

